

# SPECIFICATION DIESEL GENERATOR SET

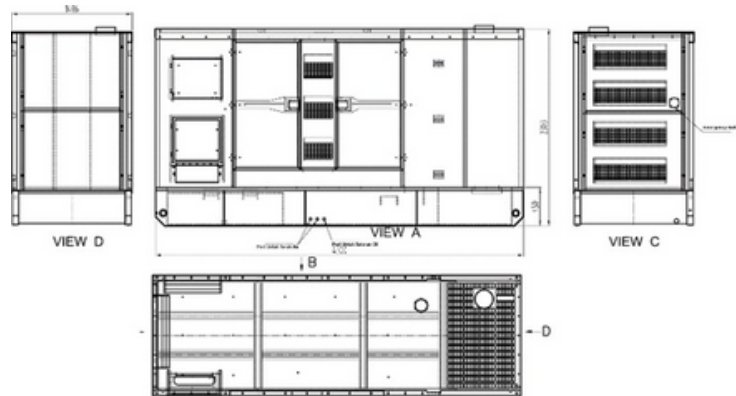

- **Features**
- High quality, reliable and complete generating sets.
- Every generating set carries a comprehensive test program which includes 25%, 50%, 75%, 100% , 110% loading test and series protecting function (example: Low oil pressure , High coolant temperature, over current/load etc.) check.
- Easy for operation and maintenance.
- Compact structure & high-strength chassis.
- Base frame design incorporates an intergrade fuel tank for at least 8 hours running.
- The canopy body painting adopts the HenKel pretreatment process and the base frame painting adopts sandblasting
- High-performance free-maintenance batteries with isolation switch.
- Anti- vibration pads are mounted between the engine/alternator feet and the base frame.
- Top lifting point and steel base frame with forklift holes, easy for transportation.
- Compliance with international electrical safety standards.
- Complete protection functions and safety labels.
- A large number of matching optional to meet the needs of various customers.
- User Manual



\*Gambar Mesin Hanya Ilustrasi

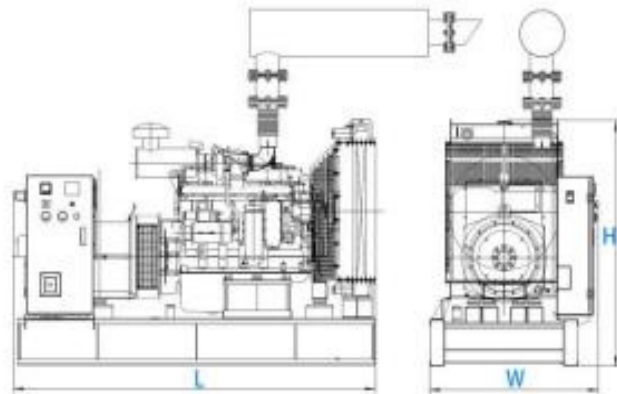

\*Gambar Mesin Hanya Ilustrasi

SPECIFICATION	OPEN TYPE	SILENT TYPE
Engine Manufac	Perkins Stamford	Perkins Stamford
Power Output	36KW/45kVA	36KW/45kVA
Phase	3 (three)	3 (three)
Frequency	50 Hz @1500 RPM	50 Hz @1500 RPM
Voltage	400V	400V
Accessories	Fuel Tank, Residential Muffler	Fuel Tank, Residential Muffler
Efficiency	88,20%	88,20%
Dimension LxWxT	2140x 750x 1360mm	2280x 1000x 1250mm
Weight	890 kg	1318 kg
Fuel tank	104	104

Also available in the following voltages:  
415/240V, 380/220V, 220/127V, 200/115V (According to customer requirements).

Rated Power/prime Power (PRP) :

Continuous running at variable load for unlimited periods with 10% overload available for 1 hour in any 12 hour period, in accordance with ISO8528.

Standby Power/Emergency Standby Power (ESP):

The maximum power available during a variable electrical power sequence, no overload on these ratings, in accordance with ISO 8528.



Genset Silent



Genset Open

\*Gambar Mesin Hanya Ilustrasi

Engine Specifications	
Engine model	VG-45P
Aspiration	turbocharged
Bore And Stroke	105 x 127 mm
Displacement	3.300 liters
Compression Ratio	17.25:1
Prime Power/speed	32KW / 1500rpm
Standby Power/speed	59.3KW / 1500rpm
Speed governor	Mechanical
Cooling System	Forced Water Cooling Cycle
Steady speed droop	≤1%
Coolant capacity	10.2L
Fuel Consumption (L/H)	207.7 g/Kw.h (at 1500RPM)

- **Heavy duty Perkins diesel engine**
- **Four stroke, water cooled, Turbocharged aspirated**
- **Direct injection fuel system**
- **Electric governor system**
- **12V DC starter and charge alternator**
- **Replaceable fuel filter and dry element air filter**
- **Cooling radiator and fan**
- **Starter battery (with lead acid) including rack and cables**
- **Flexible fuel connection hoses**
- **Industrial capacity exhaust silencer and steel bellows**
- **Operation manuals and circuit diagram documents**

## Alternator Specifications

Starter motor	DC 12V
DC 12V	DC 12V
Exciter type	Self excitation, Brushless
Power factor	0,8
Voltage adjust range	≥5%
Voltage regulation NL-FL	≤±1%
Insulation grade	H
Protection grade	IP23
Xd DIR. AXIS SYNCHRONOUS	2,1
X'd DIR. AXIS TRANSIENT	0,16
X''d DIR. AXIS SUBTRANSIENT	0,11
Xq QUAD. AXIS RECTANCE	0,13

## Control System

**DSE6120 ( Deepsea )**



**DSE4620 ( Deepsea )**



**DSE7320 ( Deepsea )**



**Suitable for > 250KVA Gen - sets**

**Suitable for for all series Gen - sets**

The Controller Display DSE6120	Control System	DSE7320 Control System
Voltage between phases(L-L)	√	√
Voltage between neutral and phase(L-N)	√	√
Frequency	√	√
3 Phase current	√	√
Real power(kW) and apparent power(kVA) Power factor	√	√
Engine speed	√	√
Running hours	√	√
Coolant temperature	√	√
Oil pressure	√	√
Battery voltage	√	√
LCD alarm indication	√	√
3 Phase mains (utility) sensing	√	√
Emergency stop button	√	√
High coolant temperature	√	√
Low oil pressure	√	√
Over current/load	√	√
under/over speed, frequency & voltage	√	√
Low/High battery voltage	√	√
Low coolant level	√	√